

45° Lateral Tee Threaded

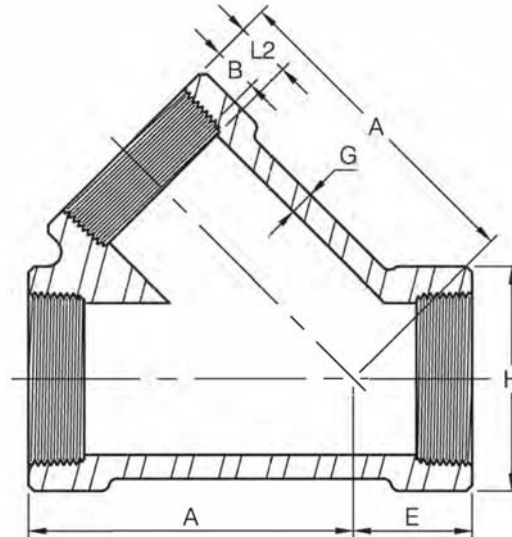

Nom. Pipe Size	A		E		G (Min)		H		Length of Thread (Min)	
	2000Lb	3000Lb	2000Lb	3000Lb	2000Lb	3000Lb	2000Lb	3000Lb	B ⁽¹⁾	L2 ⁽¹⁾
1/2"	46	55	20	23	3.18	4.09	33	38	10.9	13.6
3/4"	55	65	23	26	3.18	4.32	38	46	12.7	13.9
1"	65	73	26	31	3.68	4.98	46	56	14.7	17.3
1-1/4"	73	82	31	35	3.89	5.28	56	62	17.0	18.0
1-1/2"	82	113	35	42	4.01	5.56	62	75	17.8	18.4
2"	113	136	42	56	4.27	7.14	75	84	19.0	19.2
2-1/2"	136	-	56	-	5.61	-	92	-	23.6	28.9

- (1) Dimension B is minimum length of perfect thread. The length of useful thread (B plus threads with fully formed roots and flat crests) shall not be less than L2 (effective length of external thread) required by American National Standard for pipe threads (ANSI / ASME B1.20.1).
- (2) Dimensions in accordance with ASME B16.11-2011.