

Full Coupling Socket Weld

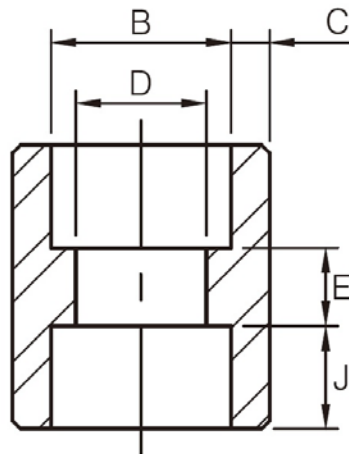

DN	Nom. Pipe Size	Socket Bore Dia. B	Bore Dia. Of Fitting D			Socket Wall Thickness C ⁽¹⁾						Laying Length E	Depth of Socket (Min) J
						3M		6M		9M			
			3M	6M	9M	Avg	Min	Avg	Min	Avg	Min		
6	1/8"	10.8	6.9	4.0	-	3.18	3.18	3.96	3.43	-	-	6.5	9.5
8	1/4"	14.2	9.3	6.4	-	3.78	3.30	4.60	4.01	-	-	6.5	9.5
10	3/8"	17.6	12.6	9.2	-	4.01	3.50	5.03	4.37	-	-	6.5	9.5
15	1/2"	21.8	15.8	11.8	6.4	4.67	4.09	5.97	5.18	9.35	8.18	9.5	9.5
20	3/4"	27.2	21.0	15.6	11.1	4.90	4.27	6.96	6.04	9.78	8.56	9.5	12.5
25	1"	33.9	26.7	20.7	15.2	5.69	4.98	7.92	6.93	11.38	9.96	12.5	12.5
32	1-1/4"	42.7	35.1	29.5	22.8	6.07	5.28	7.92	6.93	12.14	10.62	12.5	12.5
40	1-1/2"	48.8	40.9	34.0	28.0	6.35	5.54	8.92	7.80	12.70	11.12	12.5	12.5
50	2"	61.2	52.5	42.9	38.2	6.93	6.04	10.92	9.50	13.84	12.12	19.0	16.0
65	2-1/2"	73.9	62.7	-	-	8.76	7.67	-	-	-	-	19.0	16.0
80	3"	89.8	78.0	-	-	9.52	8.30	-	-	-	-	19.0	16.0
100	4"	115.2	102.3	-	-	10.69	9.35	-	-	-	-	19.0	19.0

(1) Average of socket wall thickness around periphery shall be no less than listed values. The minimum values are permitted in localized areas.

(2) 3M, 6M and 9M denote 3000Lb, 6000Lb and 9000Lb.

(3) Dimensions in accordance with ASME B16.11-2011.