

## Butt Weld 45° Branch Outlet

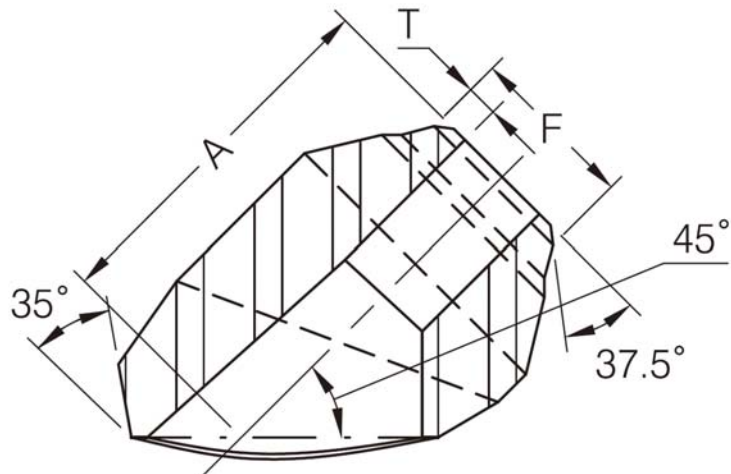

Outlet Pipe		A		T		F
DN	Inch	Min	Max	Sch 40/STD	Sch 80/XS	
8	1/4"	38.1	42.9	2.24	3.02	13.7
10	3/8"	38.1	42.9	2.31	3.20	17.1
15	1/2"	38.1	42.9	2.77	3.73	21.3
20	3/4"	44.5	50.8	2.87	3.91	26.7
25	1"	54.0	65.1	3.38	4.55	33.4
32	1-1/4"	54.0	65.1	3.56	4.85	42.2
40	1-1/2"	63.5	69.9	3.68	5.08	48.3
50	2"	73.0	88.9	3.91	5.54	60.3

- (1) Wall thickness (T) in accordance with ASME B16.10M, ASME B36.19M.  
 (2) Dimensions in accordance with MSS SP-97-2012.