

MRT Male Run Tee

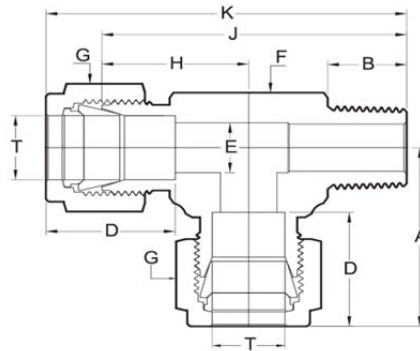

Metric

TUBE O.D.	MALE PIPE SIZE	ITEM NUMBER	A	B	D	E	F	G	H	J	K
4	1/8	MRT-4-1	24.1	10.0	13.7	2.5	12	12	17.0	35.0	42.1
4	1/4	MRT-4-2	25.4	13.0	13.7	2.5	14	12	18.3	40.6	47.7
6	1/8	MRT-6-1	25.6	10.0	15.3	5.0	12	9/16	18.0	36.0	43.6
6	1/4	MRT-6-2	26.9	13.0	15.3	5.0	14	9/16	19.3	41.6	49.1
6	3/8	MRT-6-3	29.3	14.0	15.3	5.0	17	9/16	21.7	47.3	54.9
6	1/2	MRT-6-4	32.0	17.0	15.3	5.0	22	9/16	24.4	55.8	63.3
8	1/8	MRT-8-1	28.1	10.0	16.2	6.0	14	5/8	20.3	39.6	47.4
8	1/4	MRT-8-2	28.1	13.0	16.2	6.0	14	5/8	20.3	42.6	50.4
8	3/8	MRT-8-3	31.0	14.0	16.2	6.0	17	5/8	23.2	48.8	56.7
8	1/2	MRT-8-4	33.7	17.0	16.2	6.0	22	5/8	25.9	57.3	65.1
10	1/8	MRT-10-1	31.6	10.0	17.2	8.0	17	19	23.7	45.3	53.2
10	1/4	MRT-10-2	31.6	13.0	17.2	8.0	17	19	23.7	48.3	56.2
10	3/8	MRT-10-3	31.6	14.0	17.2	8.0	17	19	23.7	49.3	57.2
10	1/2	MRT-10-4	34.3	17.0	17.2	8.0	22	19	26.4	57.8	65.7
12	1/8	MRT-12-1	35.7	10.0	22.8	10.0	20	7/8	26.0	50.5	60.2
12	1/4	MRT-12-2	35.7	13.0	22.8	10.0	20	7/8	26.0	53.4	63.1
12	3/8	MRT-12-3	35.7	14.0	22.8	10.0	20	7/8	26.0	53.4	63.1
12	1/2	MRT-12-4	36.1	17.0	22.8	10.0	22	7/8	26.4	57.8	67.5
12	3/4	MRT-12-6	38.7	19.0	22.8	10.0	27	7/8	29.0	65.0	74.7
12	1	MRT-12-8	49.7	22.0	22.8	10.0	34	7/8	40.0	85.0	94.7
14	3/8	MRT-14-3	37.9	14.0	24.4	12.0	24	25	27.5	56.5	66.9
14	1/2	MRT-14-4	37.9	17.0	24.4	12.0	24	25	27.5	59.5	69.9
14	3/4	MRT-14-6	39.4	19.0	24.4	12.0	27	25	29.0	65.0	75.4
15	3/8	MRT-15-3	38.0	14.0	24.4	12.0	24	25	27.5	56.5	67.0
15	1/2	MRT-15-4	38.0	17.0	24.4	12.0	24	25	27.5	59.5	70.0
15	3/4	MRT-15-6	39.5	19.0	24.4	12.0	27	25	29.0	65.0	75.5
16	3/8	MRT-16-3	38.2	14.0	24.4	14.0	24	25	27.5	56.5	67.2
16	1/2	MRT-16-4	38.2	17.0	24.4	14.0	24	25	27.5	59.5	70.2
16	3/4	MRT-16-6	39.7	19.0	24.4	14.0	27	25	29.0	65.0	75.7
18	3/8	MRT-18-3	39.4	14.0	24.4	16.0	27	30	29.0	60.0	70.4
18	1/2	MRT-18-4	39.4	17.0	24.4	16.0	27	30	29.0	63.0	73.4
18	3/4	MRT-18-6	39.4	19.0	24.4	16.0	27	30	29.0	65.0	75.4
20	1/2	MRT-20-4	46.6	17.0	26.0	18.0	30	32	37.6	76.2	85.2
20	3/4	MRT-20-6	46.6	19.0	26.0	18.0	30	32	37.6	76.2	85.2
22	1/2	MRT-22-4	46.9	17.0	26.0	18.0	30	32	37.6	76.2	85.5
22	3/4	MRT-22-6	46.9	19.0	26.0	18.0	30	32	37.6	76.2	85.5
25	1/2	MRT-25-4	52.4	17.0	31.3	22.0	34	1-1/2	40.0	83.0	95.4
25	3/4	MRT-25-6	52.4	19.0	31.3	22.0	34	1-1/2	40.0	85.0	97.4
25	1	MRT-25-8	52.4	22.0	31.3	22.0	34	1-1/2	40.0	85.0	97.4

MRT Male Run Tee

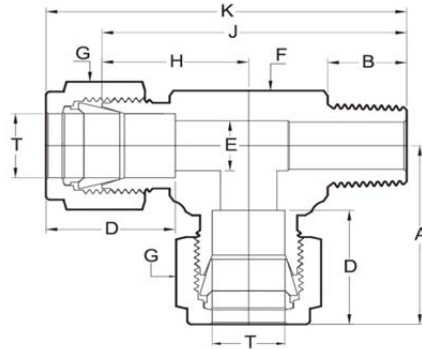

Fractional

TUBE O.D.	MALE PIPE SIZE	ITEM NUMBER	A	B	D	E	F	G	H	J	K
1/8	1/8	MRT-01-1	23.9	10.0	12.7	2.5	12	7/16	17.0	35.0	41.9
1/8	1/4	MRT-01-2	25.2	13.0	12.7	2.5	14	7/16	18.3	40.6	47.5
1/4	1/8	MRT-02-1	25.8	10.0	15.2	5.0	12	9/16	18.0	36.0	43.8
1/4	1/4	MRT-02-2	27.1	13.0	15.2	5.0	14	9/16	19.3	41.6	49.4
1/4	3/8	MRT-02-3	29.5	14.0	15.2	5.0	17	9/16	21.7	47.3	55.1
1/4	1/2	MRT-02-4	32.2	17.0	15.2	5.0	22	9/16	24.4	55.8	63.6
3/8	1/8	MRT-03-1	29.0	10.0	16.8	7.7	14	11/16	21.3	40.6	48.3
3/8	1/4	MRT-03-2	29.0	13.0	16.8	7.7	14	11/16	21.3	43.6	51.3
3/8	3/8	MRT-03-3	31.4	14.0	16.8	7.7	17	11/16	23.7	49.3	57.0
3/8	1/2	MRT-03-4	34.1	17.0	16.8	7.7	22	11/16	26.4	57.8	65.5
1/2	1/8	MRT-04-1	35.9	10.0	22.9	10.0	20	7/8	26.0	50.0	59.9
1/2	1/4	MRT-04-2	35.9	13.0	22.9	10.0	20	7/8	26.0	53.0	62.9
1/2	3/8	MRT-04-3	35.9	14.0	22.9	10.0	20	7/8	26.0	54.0	63.9
1/2	1/2	MRT-04-4	36.3	17.0	22.9	10.0	22	7/8	26.4	57.8	67.7
1/2	3/4	MRT-04-6	38.9	19.0	22.9	10.0	27	7/8	29.0	65.0	74.9
1/2	1	MRT-04-8	49.9	22.0	22.9	10.0	34	7/8	40.0	85.0	94.9
5/8	3/8	MRT-05-3	37.9	14.0	24.4	14.0	24	25	27.5	56.5	66.9
5/8	1/2	MRT-05-4	37.9	17.0	24.4	14.0	24	25	27.5	59.5	69.9
5/8	3/4	MRT-05-6	39.4	19.0	24.4	14.0	27	25	29.0	65.0	75.4
3/4	1/2	MRT-06-4	39.9	17.0	24.4	16.0	27	1-1/8	29.0	63.0	73.9
3/4	3/4	MRT-06-6	39.9	19.0	24.4	16.0	27	1-1/8	29.0	65.0	75.9
3/4	1	MRT-06-8	50.9	22.0	24.4	16.0	34	1-1/8	40.0	85.0	95.9
1	1/2	MRT-08-4	52.4	17.0	31.2	22.0	34	1-1/2	40.0	83.0	95.4
1	3/4	MRT-08-6	52.4	19.0	31.2	22.0	34	1-1/2	40.0	85.0	97.4
1	1	MRT-08-8	52.4	22.0	31.2	22.0	34	1-1/2	40.0	85.0	97.4