

FRT Female Run Tee

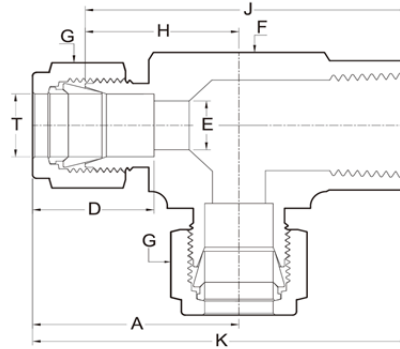

Metric

TUBE O.D.	FEMALE PIPE SIZE	ITEM NUMBER	A	D	E	F	G	H	J	K
4	1/8	FRT-4-1	25.4	13.7	2.5	14	12	18.3	37.6	44.7
4	1/4	FRT-4-2	27.8	13.7	2.5	17	12	20.7	44.3	51.4
6	1/8	FRT-6-1	26.9	15.3	5.0	14	9/16	19.3	38.6	46.2
6	1/4	FRT-6-2	29.3	15.3	5.0	17	9/16	21.7	45.3	52.9
6	3/8	FRT-6-3	32.0	15.3	5.0	22	9/16	24.4	50.8	58.4
6	1/2	FRT-6-4	34.6	15.3	5.0	27	9/16	27.0	59.0	66.6
8	1/8	FRT-8-1	28.1	16.2	6.0	14	5/8	20.3	39.6	47.4
8	1/4	FRT-8-2	30.5	16.2	6.0	17	5/8	22.7	46.3	54.1
8	3/8	FRT-8-3	33.2	16.2	6.0	22	5/8	25.4	51.8	59.6
8	1/2	FRT-8-4	35.8	16.2	6.0	27	5/8	28.0	60.0	67.8
10	1/8	FRT-10-1	31.6	17.2	8.0	17	19	23.7	47.3	55.2
10	1/4	FRT-10-2	31.6	17.2	8.0	17	19	23.7	47.3	55.2
10	3/8	FRT-10-3	34.3	17.2	8.0	22	19	26.4	52.8	60.7
10	1/2	FRT-10-4	36.9	17.2	8.0	27	19	29.0	61.0	68.9
12	1/8	FRT-12-1	35.7	22.8	10.0	20	7/8	26.0	51.0	60.7
12	1/4	FRT-12-2	35.7	22.8	10.0	20	7/8	26.0	51.0	60.7
12	3/8	FRT-12-3	36.1	22.8	10.0	22	7/8	26.4	52.8	62.5
12	1/2	FRT-12-4	38.7	22.8	10.0	27	7/8	29.0	61.0	70.7
12	3/4	FRT-12-6	49.7	22.8	10.0	34	7/8	40.0	81.0	90.7
14	3/8	FRT-14-3	37.9	24.4	12.0	24	25	27.5	55.0	65.4
14	1/2	FRT-14-4	39.4	24.4	12.0	27	25	29.0	61.0	71.4
14	3/4	FRT-14-6	50.4	24.4	12.0	34	25	40.0	81.0	91.4
15	3/8	FRT-15-3	38.0	24.4	12.0	24	25	27.5	55.0	65.5
15	1/2	FRT-15-4	39.5	24.4	12.0	27	25	29.0	61.0	71.5
15	3/4	FRT-15-6	50.5	24.4	12.0	34	25	40.0	81.0	91.5
16	3/8	FRT-16-3	38.2	24.4	14.0	24	25	27.5	55.0	65.7
16	1/2	FRT-16-4	39.7	24.4	14.0	27	25	29.0	61.0	71.7
16	3/4	FRT-16-6	50.7	24.4	14.0	34	25	40.0	81.0	91.7
18	3/8	FRT-18-3	39.4	24.4	16.0	27	30	29.0	61.0	71.4
18	1/2	FRT-18-4	39.4	24.4	16.0	27	30	29.0	61.0	71.4
18	3/4	FRT-18-6	50.4	24.4	16.0	34	30	40.0	81.0	91.4
20	1/2	FRT-20-4	46.6	26.0	18.0	30	32	37.6	75.1	84.1
20	3/4	FRT-20-6	49.0	26.0	18.0	34	32	40.0	81.0	90.0
22	1/2	FRT-22-4	46.9	26.0	18.0	30	32	37.6	75.1	84.4
22	3/4	FRT-22-6	49.3	26.0	18.0	34	32	40.0	81.0	90.3
25	1/2	FRT-25-4	52.4	31.3	22.0	34	1-1/2	40.0	81.0	93.4
25	3/4	FRT-25-6	52.4	31.3	22.0	34	1-1/2	40.0	81.0	93.4

FRT Female Run Tee

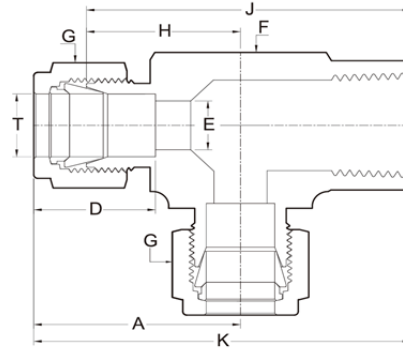

Fractional

TUBE O.D.	FEMALE PIPE SIZE	ITEM NUMBER	A	D	E	F	G	H	J	K
1/8	1/8	FRT-01-1	25.2	12.7	2.5	14	7/16	18.3	37.6	44.5
1/8	1/4	FRT-01-2	27.6	12.7	2.5	17	7/16	20.7	44.3	51.2
1/4	1/8	FRT-02-1	27.1	15.2	5.0	14	9/16	19.3	38.6	46.4
1/4	1/4	FRT-02-2	29.5	15.2	5.0	17	9/16	21.7	45.3	53.1
1/4	3/8	FRT-02-3	32.2	15.2	5.0	22	9/16	24.4	50.8	58.6
1/4	1/2	FRT-02-4	34.8	15.2	5.0	27	9/16	27.0	59.6	67.4
3/8	1/8	FRT-03-1	29.0	16.8	7.7	14	11/16	21.3	40.6	48.3
3/8	1/4	FRT-03-2	31.4	16.8	7.7	17	11/16	23.7	47.3	55.0
3/8	3/8	FRT-03-3	34.1	16.8	7.7	22	11/16	26.4	52.8	60.5
3/8	1/2	FRT-03-4	36.7	16.8	7.7	27	11/16	29.0	61.0	68.7
1/2	1/8	FRT-04-1	35.9	22.9	10.0	20	7/8	26.0	51.0	60.9
1/2	1/4	FRT-04-2	35.9	22.9	10.0	20	7/8	26.0	51.0	60.9
1/2	3/8	FRT-04-3	36.3	22.9	10.0	22	7/8	26.4	52.8	62.7
1/2	1/2	FRT-04-4	38.9	22.9	10.0	27	7/8	29.0	61.0	70.9
1/2	3/4	FRT-04-6	49.9	22.9	10.0	34	7/8	40.0	81.0	90.9
5/8	3/8	FRT-05-3	37.9	24.4	14.0	24	25	27.5	55.0	65.4
5/8	1/2	FRT-05-4	39.4	24.4	14.0	27	25	29.0	61.0	71.7
5/8	3/4	FRT-05-6	50.4	24.4	14.0	34	25	40.0	81.0	91.7
3/4	1/8	FRT-06-1	39.9	24.4	16.0	27	1-1/8	29.0	61.0	71.9
3/4	1/4	FRT-06-2	39.9	24.4	16.0	27	1-1/8	29.0	61.0	71.9
3/4	3/8	FRT-06-3	39.9	24.4	16.0	27	1-1/8	29.0	61.0	71.9
3/4	1/2	FRT-06-4	39.9	24.4	16.0	27	1-1/8	29.0	61.0	71.9
3/4	3/4	FRT-06-6	50.9	24.4	16.0	34	1-1/8	40.0	81.0	91.9
1	1/2	FRT-08-4	52.4	31.2	22.0	34	1-1/2	40.0	81.0	93.4
1	3/4	FRT-08-6	52.4	31.2	22.0	34	1-1/2	40.0	81.0	93.4