

CV Check Valve 3000PSI

Features

1. Various fixed cracking pressure springs, range from 1 to 25psig.
2. Max. allowed working pressure: 3000psi (206bar).
3. Back stopped poppet minimizes spring stress.
4. Inline check valve stops reversed flow in order to protect instrumentations.
5. End connections available with Tube, NPT or BSPT female & male thread.
6. Inline check valve stops reversed flow in order to project instrumentations.
7. With NBR O-ring ensures leak proof shut off.
8. 100% factory tested.

Material List

Item	Part Name	Q'ty	Material
1	Inlet Body	1	SS316
2	Outlet Body	1	SS316
3	Seal Ring	1	NBR
4	Poppet	1	SS316
5	Spring	1	SS304

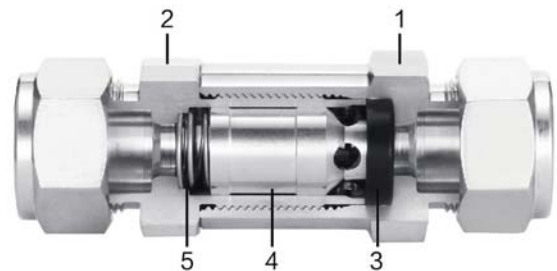

CV Check Valve 3000PSI

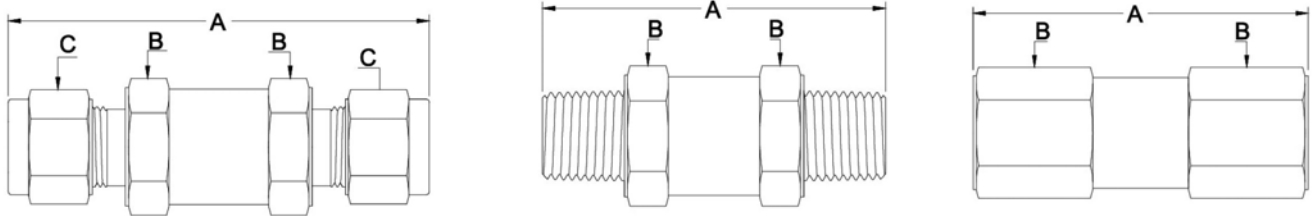

Type	Item No.	Conn./Size	Orifice		Dimensions (mm)		
		Inlet/Outlet	mm	in.	A	B	C
Tube end	CV-6OD	6mm	5	0.19	65.1	19	9/16
	CV-8OD	8mm	5	0.19	67.7	19	5/8
	CV-10OD	10mm	5	0.19	70.3	19	19
	CV-12OD	12mm	10	0.39	87.8	22	7/8
	CV-01OD	1/8"	2.5	0.10	61.8	19	7/16
	CV-02OD	1/4"	5	0.19	65.7	19	9/16
	CV-03OD	3/8"	5	0.19	70.0	19	11/16
	CV-04OD	1/2"	10	0.39	88.2	22	7/8
	CV-06OD	3/4"	11	0.43	98.9	32	1 1/8
	CV-08OD	1"	12	0.47	109.8	35	1 1/2
Male thread	CV-01M	1/8"	5	0.19	56.0	19	-
	CV-02M	1/4"	5	0.19	56.0	19	-
	CV-03M	3/8"	10	0.39	69.0	22	-
	CV-04M	1/2"	11	0.43	81.0	32	-
	CV-06M	3/4"	11	0.43	85.0	32	-
Female thread	CV-01F	1/4"	5	0.19	54.5	19	-
	CV-02F	3/8"	5	0.39	69.0	22	-
	CV-03F	1/2"	10	0.39	73.8	22	-