

## 3 Piece Ball Valve 10000PSI

### Features

1. Max. allowed working pressure: 10000psi.
2. End connections available with NPT or BSPT female thread.
3. On/off service ball valve with 2-way pattern.
4. Panel mountable.
5. 100% factory tested.

### Material List

Item	Part Name	Q'ty	Material
1	Handle	1	Zinc Alloy
2	Handle Set Screw	1	Chrome-Plated Steel
3	Packing Bolt	1	SS316
4	Stem	1	SS316
5	Sleeve	1	PTFE
6	Panel Nut	1	SS304
7	Packing	1	SS304
8	Washer	3	SS316
9	Packing	3	PTFE
10	Stem Packing	1	PTFE
11	Ball	1	SS316
12	Seat	2	PTFE
13	Seat Carrier	2	SS316
14	Packing	2	PTFE
15	End Cap	2	SS316
16	Body	1	SS316



## 3BV-10 3 Piece Ball Valve 10000PSI, 2-Way

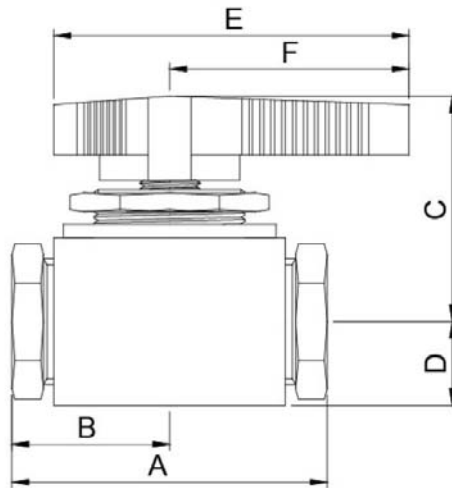

Type	Item No.	Conn./Size	Orifice		Dimensions (mm)							
		Inlet/Outlet	mm	in.	A	B	C	D	E	F	Panel Hole Size	Max Panel Thickness
Female thread	3BV-10-04F	1/2"	10	0.39	75.0	37.5	55.0	20	84.5	57	36	4
	3BV-10-06F	3/4"	10	0.39	75.0	37.5	55.0	20	84.5	57	36	4